



## Iconic Hilton Home

Lovingly and thoughtfully renovated to suit your modern lifestyle without losing any of the original character of the home, this striking three bedroom cottage offers charming kerbside appeal and easy indoor outdoor liveability.

From the wide inviting verandah to the secluded back garden the home nestles within the welcoming landscape, with tall trees providing shade and shelter.

The charming exterior is matched by the light filled and freshly updated interior, with high ceilings and wooden floors, doors and windows all adding to the Hilton character of the home.

The lounge area is separated from the cleverly designed eat in kitchen by the original brick chimney - now tucked behind a wooden screen, which can easily be removed to reveal the working fireplace. The newly installed split aircon provides more than enough cooling and heating, supplemented by ceiling fans in the living and bedrooms. Newly installed French doors open out onto the large rear wooden deck, expanding the living area to the outdoors and creating a wonderful environment for entertaining, relaxing, living and playing.

Land: 319m2

## Hilton 93 Snook Crescent

**HOUSE:** 3 BED | 1 BATH | 2 CAR  
**VIEW:** Sun, 25 Oct @ 12:30 pm - 1:00 pm  
**CONTACT:** Cindy Loffell 0412120050  
**OFFICE:** Perth 08 9336 1166  
**ONLINE:** <https://www.dethridgegroves.com.au>

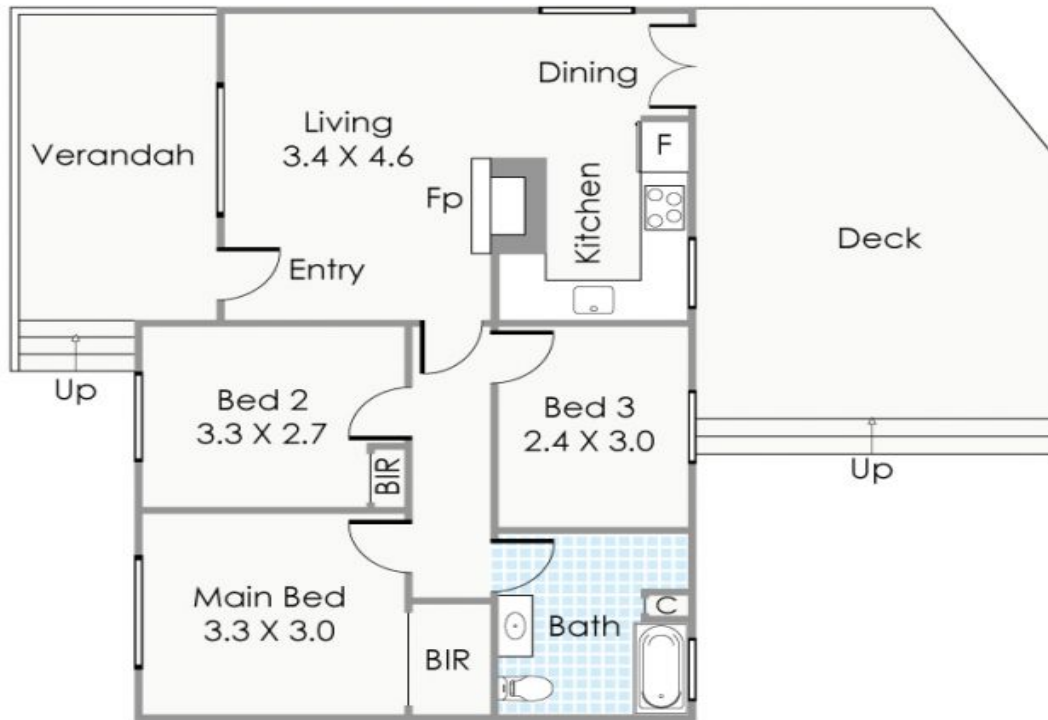

COMMON DRIVEWAY

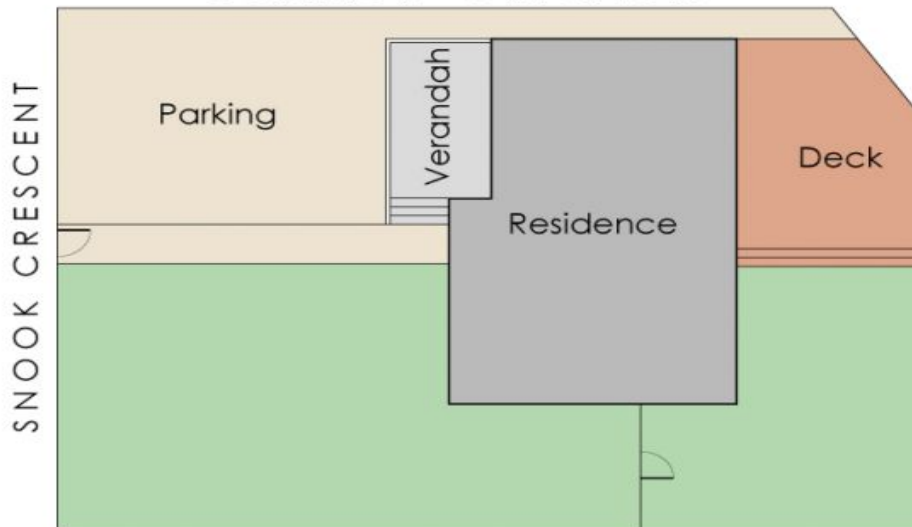

Approximate Areas

Residence:	68m <sup>2</sup>
Verandah:	13m <sup>2</sup>
Deck:	28m <sup>2</sup>
Total Area:	109m <sup>2</sup>

This floorplan is for illustration purposes only to show the layout of the property. Not to be used for any other purpose. [www.crbcreative.com.au](http://www.crbcreative.com.au)



**93 Snook Crescent, Hilton**

**Hilton, WA**  
93 Snook Crescent

Disclaimer: All information contained herein is gathered from sources we believe reliable. We have no reason to doubt its accuracy, however we cannot guarantee it. All dimensions, measurements and distances are approximates. All interested parties should make and rely upon their own enquiry.  
©The Agency Australia Pty Ltd T/A The Agency Estate Agents ABN 90 169 023 233 Corp Licence 10002231 - 397 New South Head Road, Double Bay NSW 2028 | Sydney Australia

