



Simply Charming!

Lovingly and thoughtfully renovated to suit modern family living without losing any of the original character of the home, this striking three bedroom home offers charming kerbside appeal.

From the wide inviting verandah to the secluded back garden the home nestles within the welcoming landscape, with tall trees providing shade and shelter.

The charming exterior is matched by the light filled and freshly updated interior, with a traditional brick fire place in pride of place in the living area which leads through to the cleverly designed eat in kitchen. The high ceilings and wooden floors, doors and windows all add to the Hilton character of the home.

Newly installed French doors open out onto the large rear alfresco, expanding the living area to the outdoors and creating a wonderful environment for entertaining, relaxing, living and playing.

Hilton 93 Snook Crescent

| | |
|-----------------|---|
| HOUSE: | 3 BED 1 BATH 2 CAR |
| VIEW: | Wed, 26 Feb @5:15 pm - 5:45 pm |
| CONTACT: | Cindy Loffell 0412 120 050 |
| OFFICE: | Perth 08 9336 1166 |
| ONLINE: | https://www.dethridgegroves.com.au |

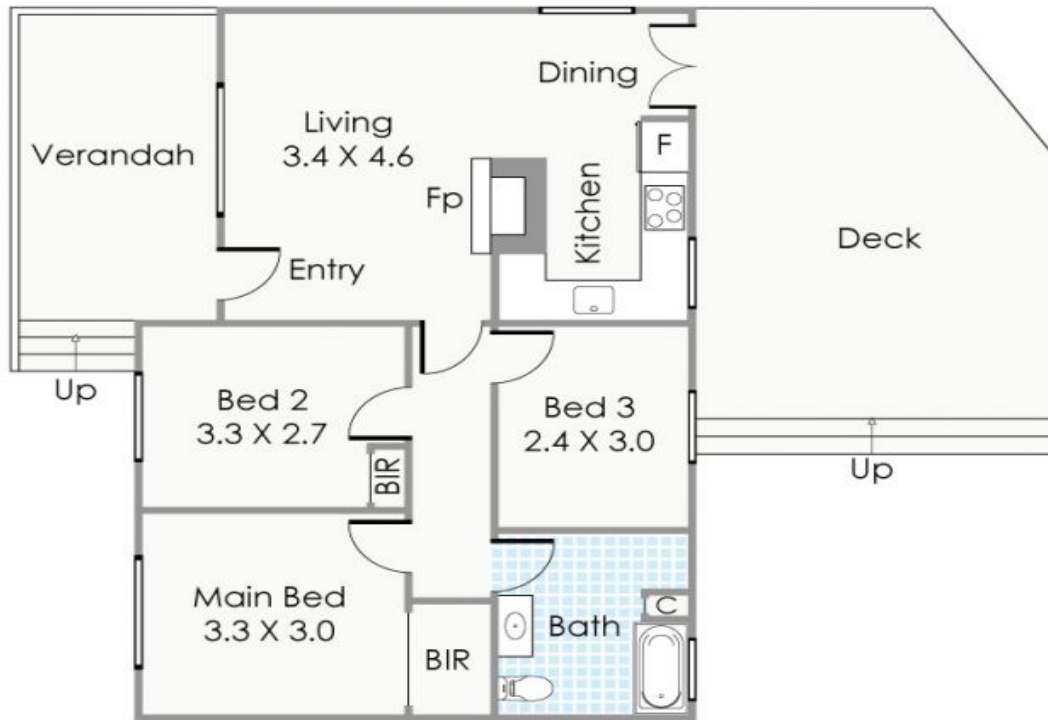

COMMON DRIVEWAY

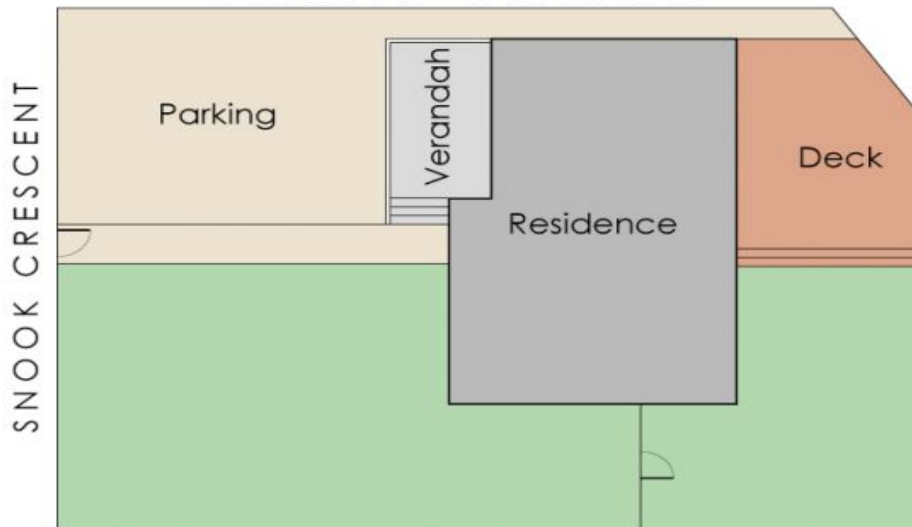

Approximate Areas

| | |
|-------------|-------------------|
| Residence: | 68m ² |
| Verandah: | 13m ² |
| Deck: | 28m ² |
| Total Area: | 109m ² |

This floorplan is for illustration purposes only to show the layout of the property. Not to be used for any other purpose. www.crbcreative.com.au



93 Snook Crescent, Hilton

Hilton, WA
93 Snook Crescent

Disclaimer: All information contained herein is gathered from sources we believe reliable. We have no reason to doubt its accuracy, however we cannot guarantee it. All dimensions, measurements and distances are approximates. All interested parties should make and rely upon their own enquiry.
©The Agency Australia Pty Ltd T/A The Agency Estate Agents ABN 90 169 023 233 Corp Licence 10002231 - 397 New South Head Road, Double Bay NSW 2028 | Sydney Australia

