



## Only The Very Best

This delightful Hilton cottage has been fully renovated and extended to create a wonderful contemporary 3 bedroom family residence offering a stylish home with modern practicality that will impress.

The original cottage accommodates 3 large bedrooms and 2 modern bathrooms. The main bedroom affords a very generous en-suite bathroom, built in robes and large window with a street outlook. The welcoming passageway and all bedrooms are white, light and bright making this a most attractive part of the home.

The large contemporary living extension fully embraces modern living with a fabulous family kitchen, spacious living room and enjoys a wonderful indoor-outdoor flow to the entertaining deck and shady garden beyond. In charcoal finishes the kitchen has top of the range appliances, generous stone bench space, excellent storage and would please the fussiest of cooks.

## Hilton 12 Lee Avenue

<b>HOUSE:</b>	3 BED   2 BATH   2 CAR
<b>VIEW:</b>	Sat, 29 Feb @11:00 am - 11:45 am
<b>CONTACT:</b>	Mary Burns 0413 749 944
<b>OFFICE:</b>	Perth 08 9336 1166
<b>ONLINE:</b>	<a href="https://www.dethridgegroves.com.au">https://www.dethridgegroves.com.au</a>

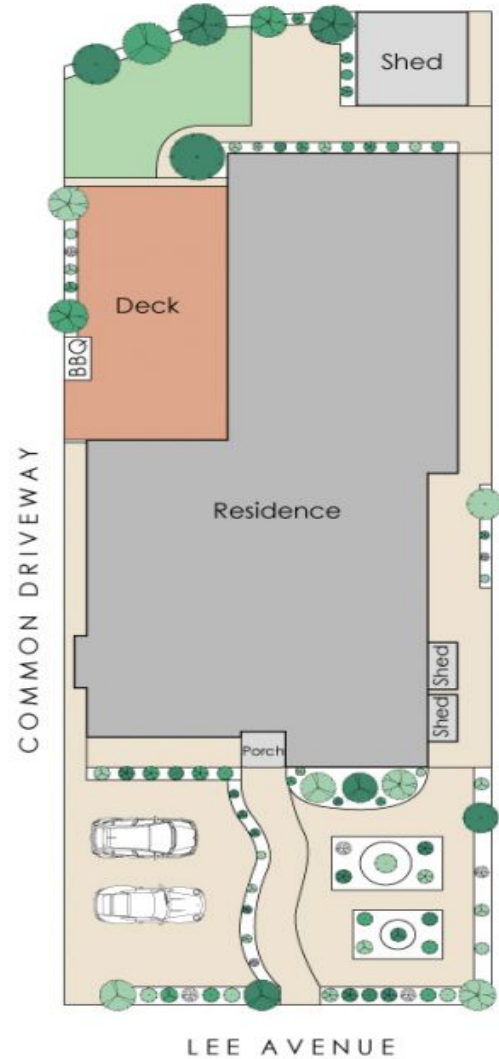

Approximate Areas

Residence:	151m <sup>2</sup>
Porch:	3m <sup>2</sup>
Total Area:	154m <sup>2</sup>

This floorplan is for illustration purposes only to show the layout of the property. Not to be used for any other purpose. [www.cribcreative.com.au](http://www.cribcreative.com.au)



12 Lee Avenue, Hilton

**Hilton, WA**  
12 Lee Avenue

Disclaimer: All information contained herein is gathered from sources we believe reliable. We have no reason to doubt its accuracy, however we cannot guarantee it. All dimensions, measurements and distances are approximates. All interested parties should make and rely upon their own enquiry.  
©The Agency Australia Pty Ltd T/A The Agency Estate Agents ABN 90 169 023 233 Corp Licence 10002231 - 397 New South Head Road, Double Bay NSW 2028 | Sydney Australia

