



## Sunsets, Mid-Century Style

Located in an elevated position in "Hilton Heights", this immaculate 1960's renovated home is an ideal fit for those lovers of mid-century style and sunsets, boasting views across the Hilton tree tops over greater Fremantle to the ocean.

Set back behind a gated frontage, walk past established lawn and shrubs to the stairs leading to the front balcony which stretches the entire length of the home to the covered front deck, which is perfect for year 'round entertaining and relaxing with friends or family whilst watching the sun set over greater Fremantle and enjoying the tree lined vista.

Bi-fold doors open to connect to the open plan living offering an abundance of natural light, clean lines and new large windows to soak in the expansive view. The welcoming and easy flow floor plan has high ceilings and Wandoo timber floors combined with a mixture of wall textures, to create a very special and unique living environment.

Council Rates: \$1,109/year (approx)  
Land: 443m<sup>2</sup>

## Hilton 4 Ethelwyn Street

**HOUSE:** 3 BED | 1 BATH | 2 CAR  
**CONTACT:** Lauri Curtain 0422 478 150  
**OFFICE:** Perth 08 9336 1166  
**ONLINE:** <https://www.dethridgegroves.com.au>

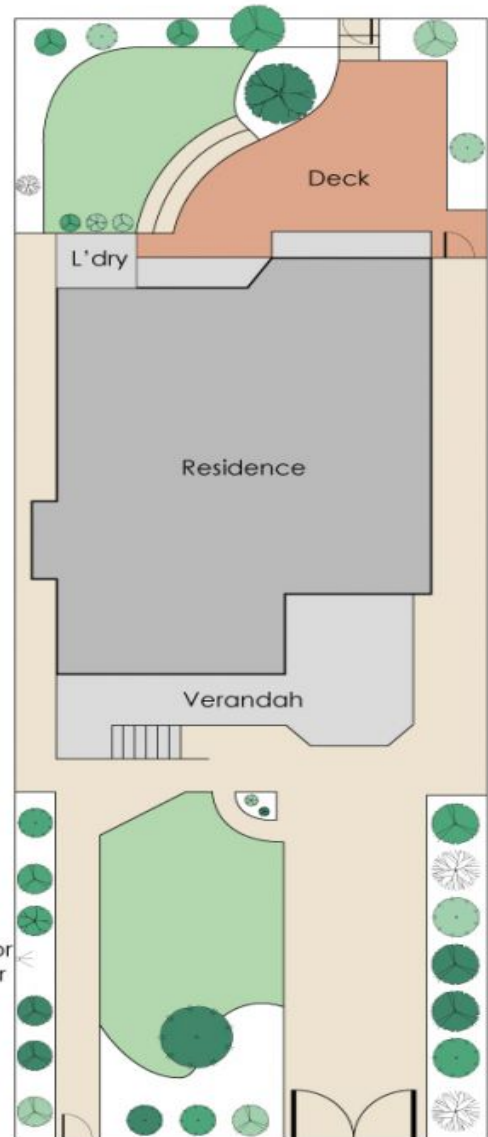
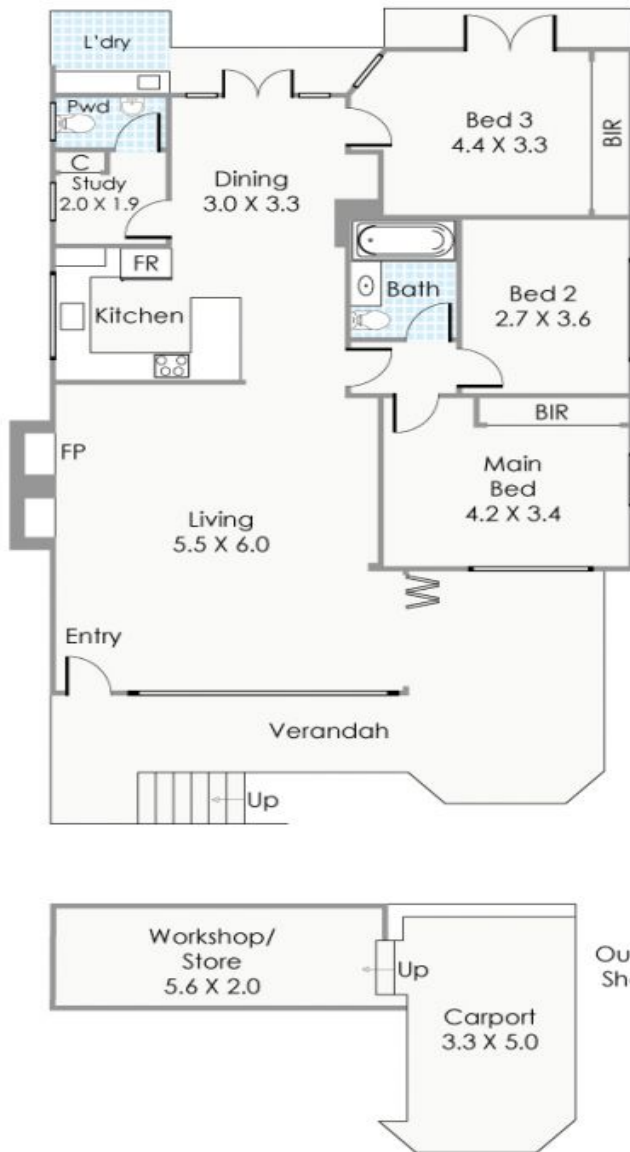

ETHELWYN STREET

Approximate Areas

Residence:	115m <sup>2</sup>
Carport:	15m <sup>2</sup>
Workshop/ Store:	11m <sup>2</sup>
Verandah:	29m <sup>2</sup>
Total Area:	170m <sup>2</sup>

This floorplan is for illustration purposes only to show the layout of the property. Not to be used for any other purpose. [www.cribcreative.com.au](http://www.cribcreative.com.au)



4 Ethelwyn Street, Hilton

**Hilton, WA**  
4 Ethelwyn Street

Disclaimer: All information contained herein is gathered from sources we believe reliable. We have no reason to doubt its accuracy, however we cannot guarantee it. All dimensions, measurements and distances are approximates. All interested parties should make and rely upon their own enquiry.  
©The Agency Australia Pty Ltd T/A The Agency Estate Agents ABN 90 169 023 233 Corp Licence 10002231 - 397 New South Head Road, Double Bay NSW 2028 | Sydney Australia

