



## Under Offer 2nd Week

This is an iconic Fremantle residence gifted with history, charm, land and extensive ocean views. The position of the home in a prominent Fremantle Street with a distinct facade on a large, quarter acre block makes this property a rare find in the current market. 77 Solomon Street, also known as 'Atwell House', was built in 1898 by prominent local businessman, Henry Atwell. This 2 storey limestone residence with impressive central hallway is grand in size and architecture. Wide, sweeping wraparound verandas embrace the home and attractive French doors allow indoor/outdoor access from several of the rooms. The period features are endless with not less than six fireplaces complete with ornate overmantels, wide jarrah floorboards and high, embellished ceilings which all compliment the beautifully proportioned rooms throughout.

Land: 1068m2

## Fremantle 77 Solomon Street

**HOUSE:** 5 BED | 2 BATH | 2 CAR  
**CONTACT:** Nick French 0407 884 035  
 Linda Digby 0402 122 267  
**OFFICE:** Perth 08 9336 1166  
**ONLINE:** <https://www.dethridgegroves.com.au>



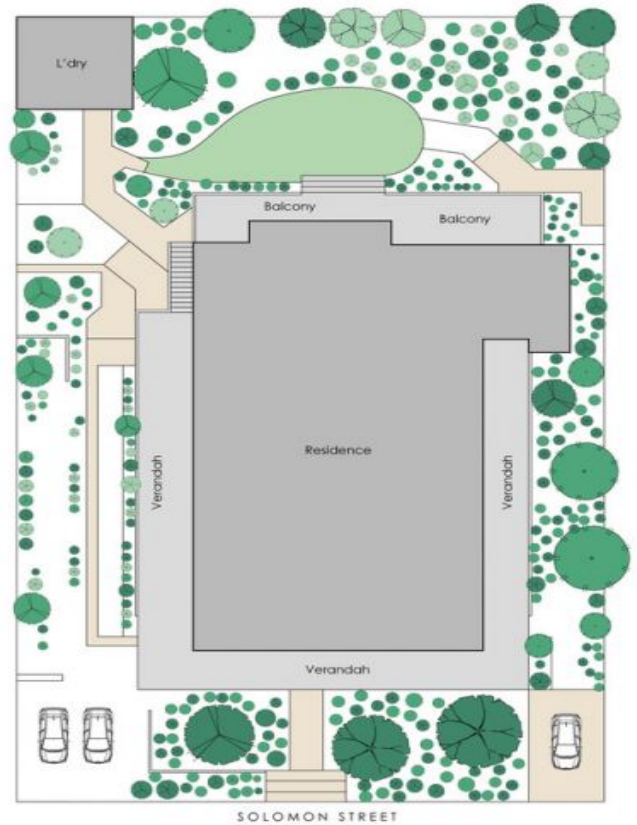
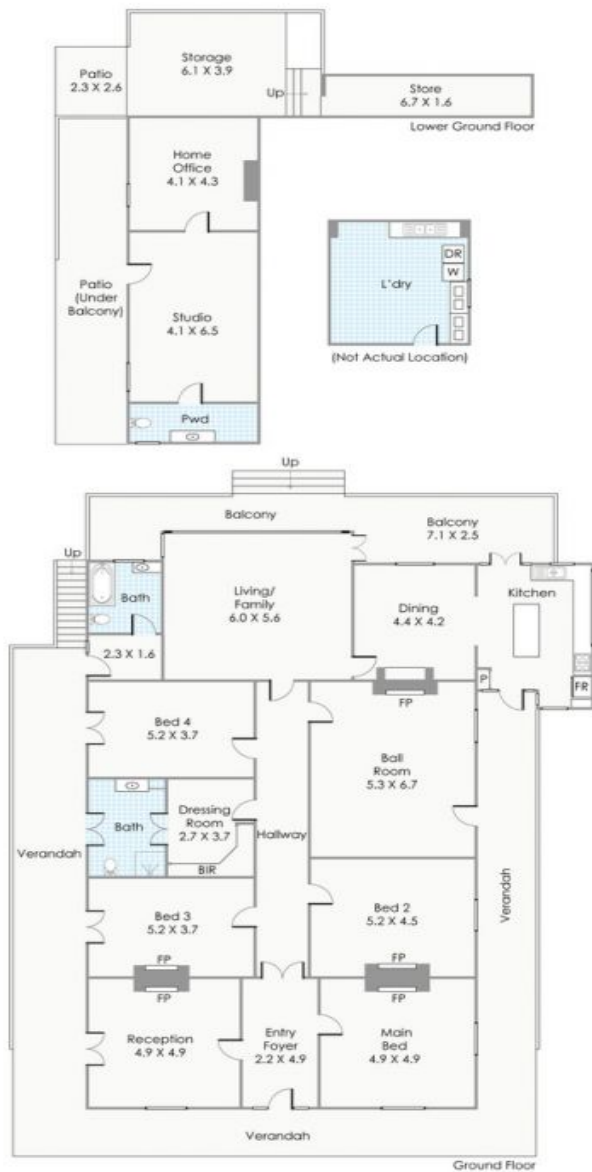

Approximate Areas

<b>LOWER GROUND FLOOR</b>	
Residence:	87m <sup>2</sup>
Patio:	36m <sup>2</sup>
<b>GROUND FLOOR</b>	
Residence:	288m <sup>2</sup>
Balcony:	31m <sup>2</sup>
Verandah:	102m <sup>2</sup>
L'dry:	20m <sup>2</sup>
<b>Total Area:</b>	<b>564m<sup>2</sup></b>

This floorplan is for illustration purposes only to show the layout of the property. Not to be used for any other purpose. [www.cribcreative.com.au](http://www.cribcreative.com.au)



**77 Solomon Street, Fremantle**



## Fremantle, WA

77 Solomon Street

Disclaimer: All information contained herein is gathered from sources we believe reliable. We have no reason to doubt its accuracy, however we cannot guarantee it. All dimensions, measurements and distances are approximates. All interested parties should make and rely upon their own enquiry.  
 ©The Agency Australia Pty Ltd T/A The Agency Estate Agents ABN 90 169 023 233 Corp Licence 10002231 - 397 New South Head Road, Double Bay NSW 2028 | Sydney Australia

