



## UNDER OFFER by Lauri Curtain

In an idyllic setting on a generous 911sqm lot, zoned R20 with paths winding past majestic trees, shrubs, quiet sitting spots and a trickling pond, this meticulously maintained weatherboard and iron home has been remodeled allowing a flowing connection with the picturesque garden setting. Welcome to 35 Snook Crescent, blessed with a unique charm, this gorgeous character home radiates an inviting "down south" feel from behind the front rustic curved limestone wall.

Elevated above the street, the northerly orientated front deck offers one of the many comfortable sitting spots and inside beautiful Jarrah floors, leadlight windows, high ceilings and French doors, affords a timeless appeal that will welcome you home time and time again. In the centre of the home, the classic country style kitchen provides modern appliances and adjoins the open living area creating a lovely living environment opening out to the rear garden. While a very large covered outdoor rear deck creates an all year round entertaining space that is hard to surpass.

Land: 911m2

## Hilton 35 Snook Crescent

**HOUSE:** 3 BED | 1 BATH | 3 CAR  
**CONTACT:** Lauri Curtain 0422 478 150  
**OFFICE:** Perth 08 9336 1166  
**ONLINE:** <https://www.dethridgegroves.com.au>



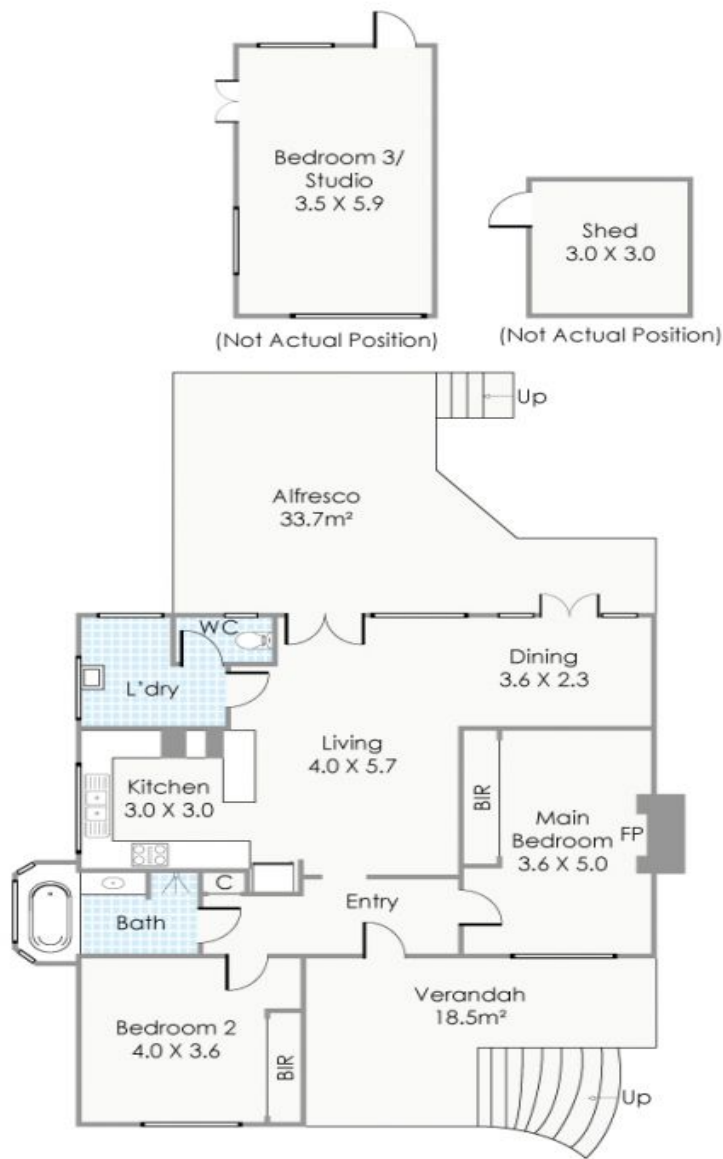

SNOOK CRESCENT

Approximate Areas

GROUND FLOOR

Residence:	96m <sup>2</sup>
Studio:	21m <sup>2</sup>
Alfresco:	34m <sup>2</sup>
Verandah:	19m <sup>2</sup>
Shed:	9m <sup>2</sup>
<b>Total Area:</b>	<b>179m<sup>2</sup></b>

This floorplan is for illustration purposes only to show the layout of the property. Not to be used for any other purpose. [www.cribcreative.com.au](http://www.cribcreative.com.au)



**35 Snook Crescent, Hilton**

**Hilton, WA**  
35 Snook Crescent

Disclaimer: All information contained herein is gathered from sources we believe reliable. We have no reason to doubt its accuracy, however we cannot guarantee it. All dimensions, measurements and distances are approximates. All interested parties should make and rely upon their own enquiry.  
©The Agency Australia Pty Ltd T/A The Agency Estate Agents ABN 90 169 023 233 Corp Licence 10002231 - 397 New South Head Road, Double Bay NSW 2028 | Sydney Australia

