

## Move In and Make Memories

Home to the current family for the past 60 years, if 37 Oldham Crescent could talk, it would tell you about looking out for the bus at the top of Paget St whilst waiting on the front porch or how the now very large and mature Liquid Amber Tree first came home in a suitcase from Victoria many years ago.

On a large 861sqm lot on the corner of Howson Street, zoned R20 this original and beautifully maintained, double brick and tile, four bedroom, one bathroom home offers a new family the opportunity to move in and make their own memories.

With many character features such as high ceilings, floor boards (under carpet) and sash windows, the home offers the possibility to move in now and renovate later. The living room with gas heater, split system air conditioner and ceiling fan looks out through double glass doors over the front porch to the large front garden. Mature shrubs and trees screen the home from the street creating a wonderful space for children to play or plant a large veggie garden.

Land: 861m2

## Hilton 37 Oldham Crescent

**HOUSE:** 4 BED | 1 BATH | 2 CAR  
**CONTACT:** Lauri Curtain 0422 478 150  
**OFFICE:** Perth 08 9336 1166  
**ONLINE:** <http://www.dethridgegroves.com.au>

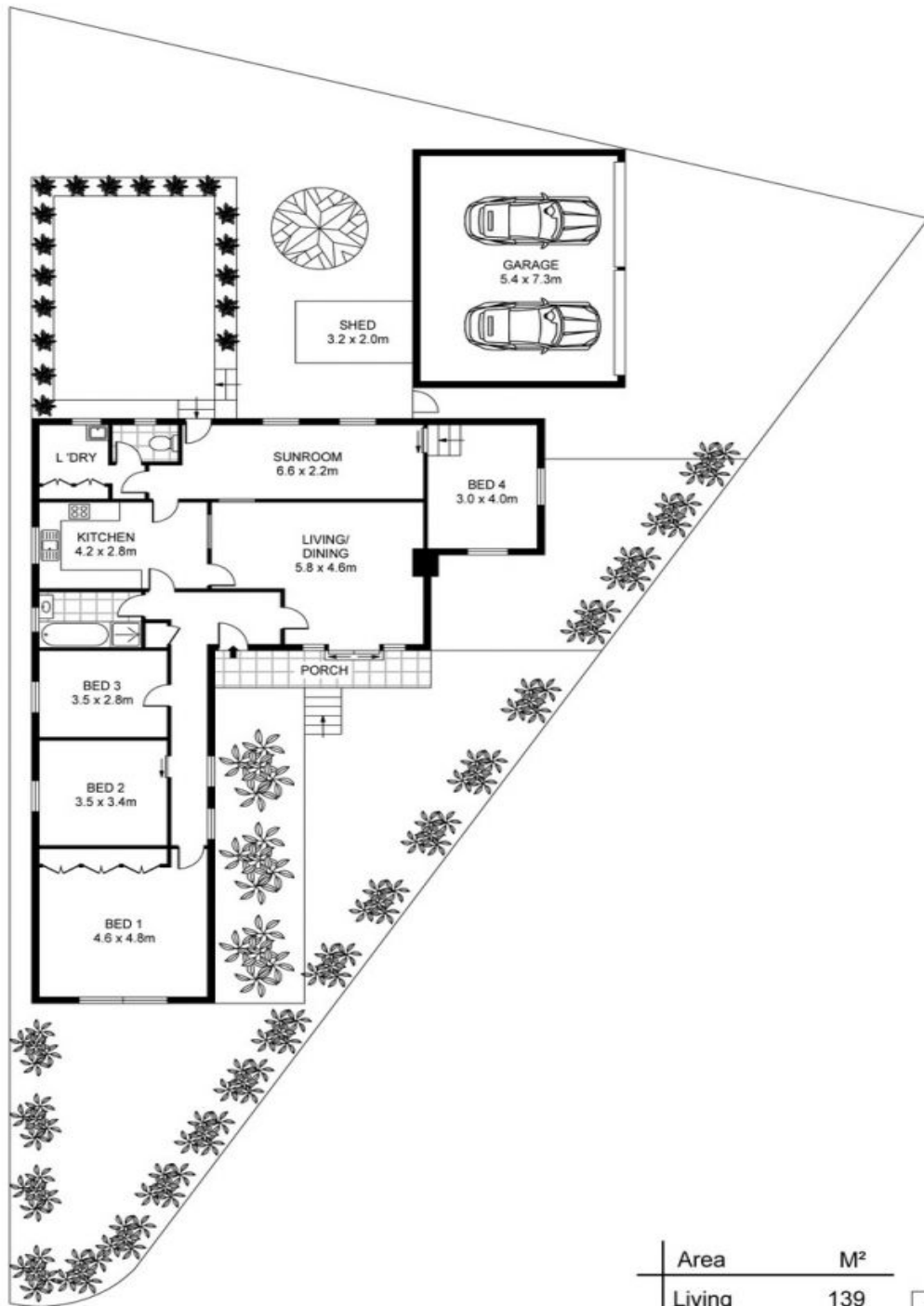

Scale in metres. Indicative only. Dimensions are approximate. All information contained herein is gathered from sources we believe to be reliable. However we cannot guarantee its accuracy and interested persons should rely on their own enquiries

Area	M <sup>2</sup>
Living	139
Garage	39
<b>Total</b>	<b>178</b>



37 Oldham Crescent, Hilton

Floor Plan: [www.project3axis.photography](http://www.project3axis.photography)

## Hilton, WA

37 Oldham Crescent

Disclaimer: All information contained herein is gathered from sources we believe reliable. We have no reason to doubt its accuracy, however we cannot guarantee it. All dimensions, measurements and distances are approximates. All interested parties should make and rely upon their own enquiry.  
 ©The Agency Australia Pty Ltd T/A The Agency Estate Agents ABN 90 169 023 233 Corp Licence 10002231 - 397 New South Head Road, Double Bay NSW 2028 | Sydney Australia